



Key Industries:

- Automotive
- Energy
- Beverage & Liquid
- Food
- Steel Processing
- Material Handling
- Printing and Packaging
- Pulp & Paper

Key Applications:

- Bottling and filling lines
- Cartonners and case packers
- Conveyors
- Films and shrink wrappers
- Labeling equipment
- Positive displacement pumps

Autogard 206W Torque Limiter

Combining the reliability of the Autogard 200 Series Torque Limiter with the proven quality of the Falk Wrapflex Elastomeric Coupling.

Rexnord combines the quality and reliability of the Autogard® 200 Series Torque Limiter with the proven reputation of the Falk® Wrapflex® Elastomeric Coupling, offering customers the Autogard 206W Torque Limiter. With the coupling adapted to the torque limiter, it provides customers overload protection in shaft-to-shaft applications where misalignment needs to be accommodated.

The Autogard 200 Series Torque Limiter is a reliable and robust mechanical device that protects equipment within the automotive, energy, steel processing, and printing and packaging industries, and more, during shock loads, overloads and jams. The torque limiter eliminates the threat of damage by disconnecting the inertia in the drive train, and is offered in single position, random position or manual reset styles.

The Falk Wrapflex Elastomeric Coupling's polyurethane element provides excellent wear and chemical resistance to ensure long life while also boasting a patented axial thrust tab feature that reduces axial thrust forces on connected equipment.

Features and benefits:

- Accurate and consistent torque setting with instant and complete disengagement of the driving and driven inertias, with bi-directional and repeatable protection to help protect your equipment and prevent costly downtime
- Adjustable over a wide range of torques to meet specific application requirements
- The Falk Wrapflex Elastomeric Coupling is torsionally resilient and accommodates angular, parallel and axial misalignment for many applications, while its patented design ensures long life



Autogard 206W Torque Limiter dimensional drawing

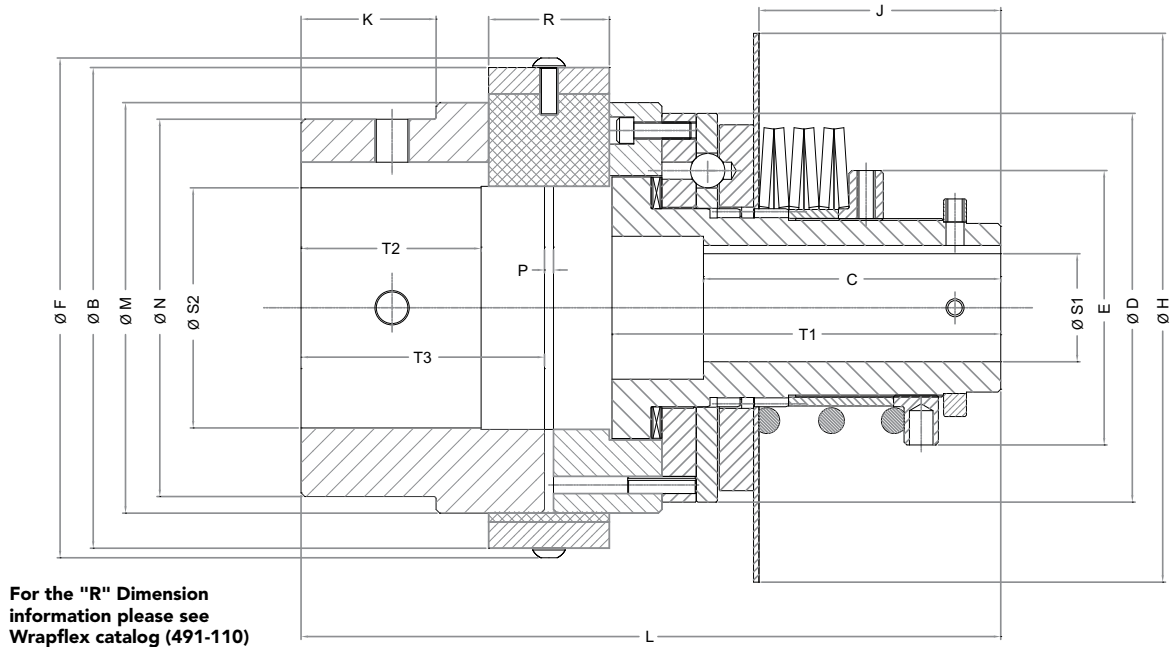

Size	Torque		Speed ^①			Weight ^③ kg	Mass Moment of Inertia MR ^{2③} kgm ²	Max. Coupling Misalignments		
	Type AC or AF Nm	Type ACT Nm	Type AC rpm	Type ACT rpm	Type AF rpm			Axial ±mm	Angular degrees	Parallel mm
1/5R	1-44	3-69	200	500	2,000	1.65	0.00091	0.2	1	1.0
2/30R	6-226	9-384	200	500	2,000	6.82	0.013	0.2	1	2.0
3/40R	6-678	9-854	200	500	2,000	14.0	0.038	0.5	1	2.0
4/50R	90-1,130	113-1,774	200	500	2,000	28.0	0.14	0.5	1	2.0
5/60R	141-2,540	158-2,937	200	500	2,000	61.0	0.47	0.5	1	2.0
5S ^② /80R	938-7,627	1,130-8,474	200	500	–	130.0	1.9	0.6	1	2.0

① Higher speeds may be allowed under certain conditions. Please consult Rexnord.
 ② 5S is available in Type AC and ACT only.
 ③ Weight and Mass Moment of Inertia apply to maximum (S1 and S2) bores.

Size	Max. Bore		B mm	C mm	D mm	E mm	F mm	H mm	J mm	K mm	L mm	M mm	N mm	P mm	T1 mm	T2 mm	T3 mm
	S1 mm ^①	S2 mm ^①															
1/5R	12	38	76	51	60	33 AF	80	83	50	20	140	64	60	2	90	25	35
2/30R	25	65	147	67	102	56 AF	153	140	51	46	187	118	105	2	95	57	75
3/40R	38	85	182	89	127	ø79	190	165	86	54	251	150	130	5	137	66	88
4/50R	50	105	231	127	159	ø108	239	203	106	59	308	190	178	5	165	76	105
5/60R	76	135	267	165	216	ø152	278	305	134	75	389	228	210	5	216	100	135
5S/80R	102	190	370	191	292	ø178	381	305	120	102	473	328	270	6	235	140	185

① Standard bore tolerances = H8 + standard key fit.